

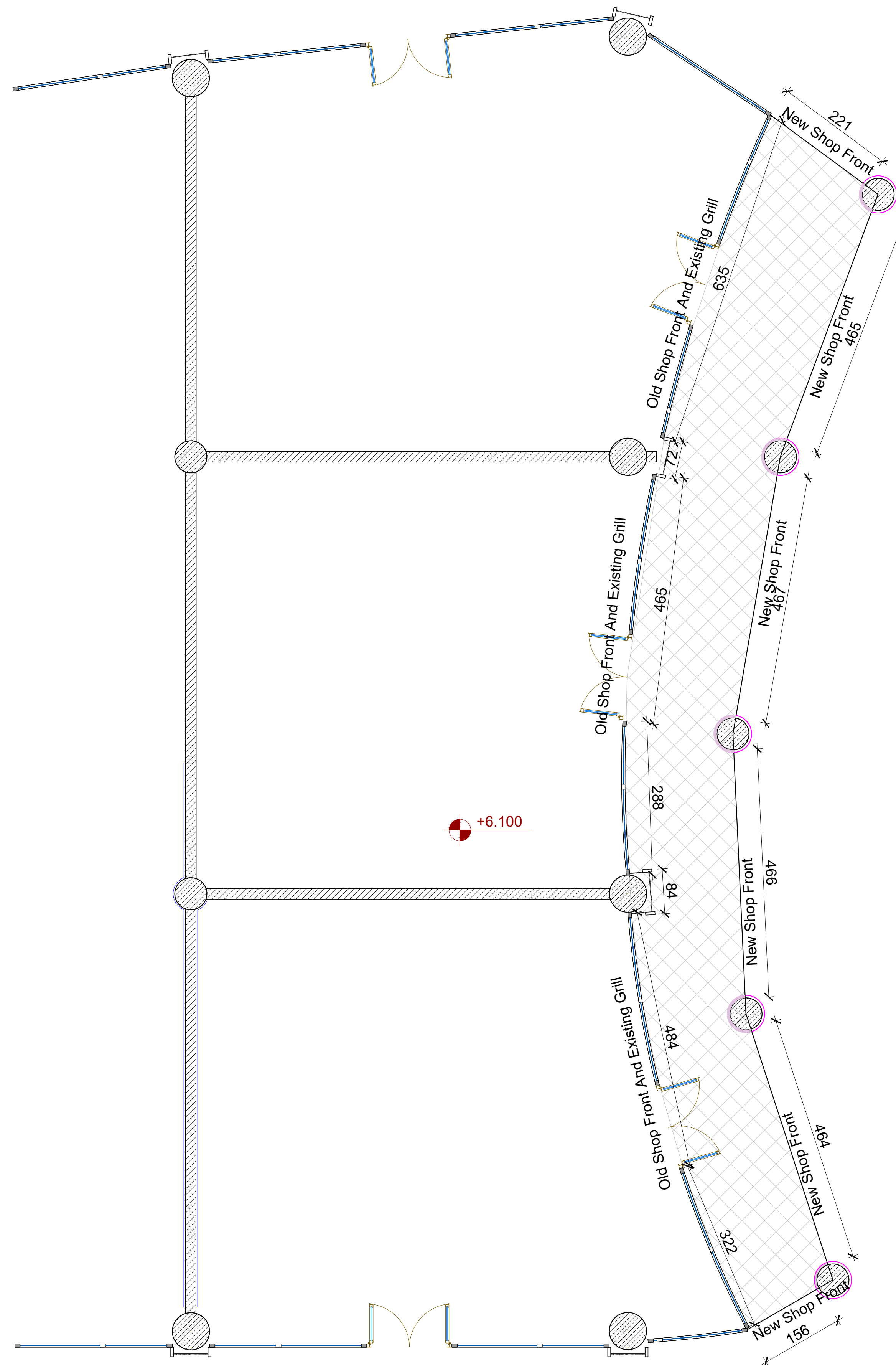
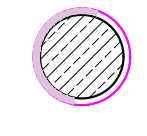

Annex 3: Scope of Work



1. **Marked Area of  Suspended Ceiling To Be Removed and Fixed Properly**
2. **Column Cladding  Should be removed Only in Marked Areas**
3. **Grills Above Old Shop Front Should be Relocated above New Shop Front**
4. **Install New Shop Front**
Note: Old Substructure Frame Should Be Used For Relocation