

10	9	8	7	6	5	4	3	2	1
----	---	---	---	---	---	---	---	---	---

KEY PLAN
1 : 200

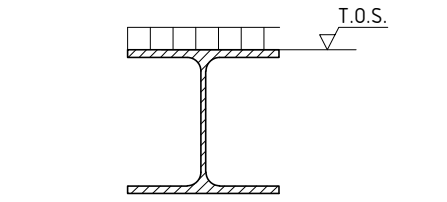

STANDARD DETAIL 1:
ELECTROWELDED GRATING EDGE
1 : 10

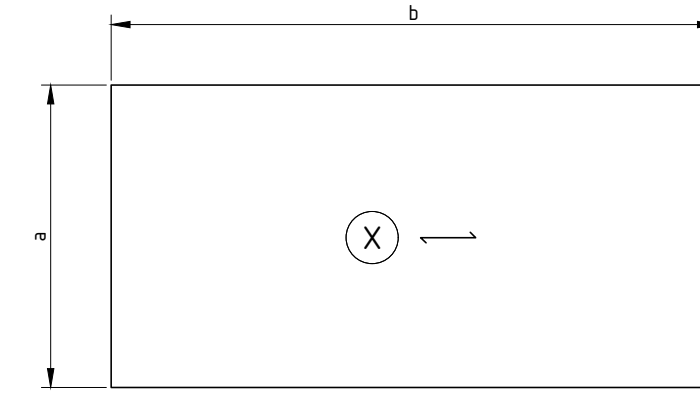
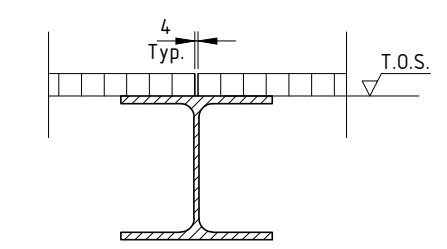

STANDARD DETAIL 2: DISTANCE
BETWEEN ELECTROWELDED GRATING
PANELS
1 : 10

NP	a	b	UMTS
1	421	1910	1
2	421	1485	1
3	656	1000	2
6	1316	1150	1
13	1150	1075	1
14	1000	1945	1
15	765	1945	1
16	1000	780	1
18	866	780	1
19	464	1945	1
20	336	950	1
21	1050	2083	1
22	1050	1910	1
23	741	2145	1
24	1042	535	1
25	587	2145	1
26	1000	2145	2
27	1033	2145	1
28	288	1000	1
29	1073	1150	1

Notes:
1. ALL DIMENSIONS ARE IN mm COORDINATES AND ELEVATIONS ARE IN m UNLESS OTHERWISE INDICATED.
2. GRATING SPECIFICATION:
- S235JR OR HIGHER STRENGTH STEEL HOT DIP GALVANIZED 30 mm THICKNESS GRATING PANELS.
- 1 x 2 m MAXIMUM APPROX. PANEL SIZE.
- 30 x 23 MESH (34 mm BETWEEN BEARING BARS AND 23 mm BETWEEN LINKING RODS ACC. WITH ISO 14122 NOT ALLOWING A 20 mm DIAMETER PASSING THROUGH)
- 30x3 BEARING BAR SECTION AND x6 mm LINKING TWISTED ROD
- 200 mm TYPICAL MAXIMUM SPAN FOR 5 kN/m² ALLOWABLE LOAD.
- ALL STAIR STEPS TO HAVE ANTISLIP EDGE.
- ALL PANELS EDGES FACING VOIDS FOR EQUIPMENT OR PIPING WITHOUT HANDRAIL KICKPLATE WILL INCLUDE A BUILT-IN WELDED AND GALVANIZED EQUIVALENT KICKPLATE.
3. CONSTRUCTOR SHOULD CHECK ALL DIMENSIONS BEFORE FABRICATION AND CONSTRUCTION. ALSO ALL PIPING AND CABLE TRAY SUPPORTS AND PIPE CROSSING NOT SHOWN MUST BE CONSIDERED PRIOR FABRICATION. ANY REPAIR OR MODIFICATION MUST BE PROPERLY FIXED AND GALVANIZATION RESTORED.
4. GRATING CONNECTION TO THE STRUCTURES TO BE DONE WITH ADEQUATE VENDOR REMOVABLE CLAMPS.

0	PCR	28/10/2022	ATB	28/10/2022	ATB	28/10/2022	FOR CONSTRUCTION
Rev.	Author/Date	Checked/Date	Approved/Date	Description			
Customer: JSC RMG Auramine LLC			Project: BEQTAQARI DETAIL ENGINEERING				
			Title: GRINDING PLANT GRATING LAYOUT T.O.S. +720.920 +721.121 +721.670 +721.940				
			3d model: Customer doc. code: Doc. code: P1384-200-ST-010				
Area: 200			Scale: 1:50	Format: A1	Rev: 0		